

JayMarc Homes, LLC  
 7525 SE 24th St, #487  
 Mercer Island, WA 98040  
 425 281 2706

Site Plan  
 9619 SE 34th St.  
 Mercer Island, WA 98040

Drawn by  
 Gary Upper

1/31/24

A2.0

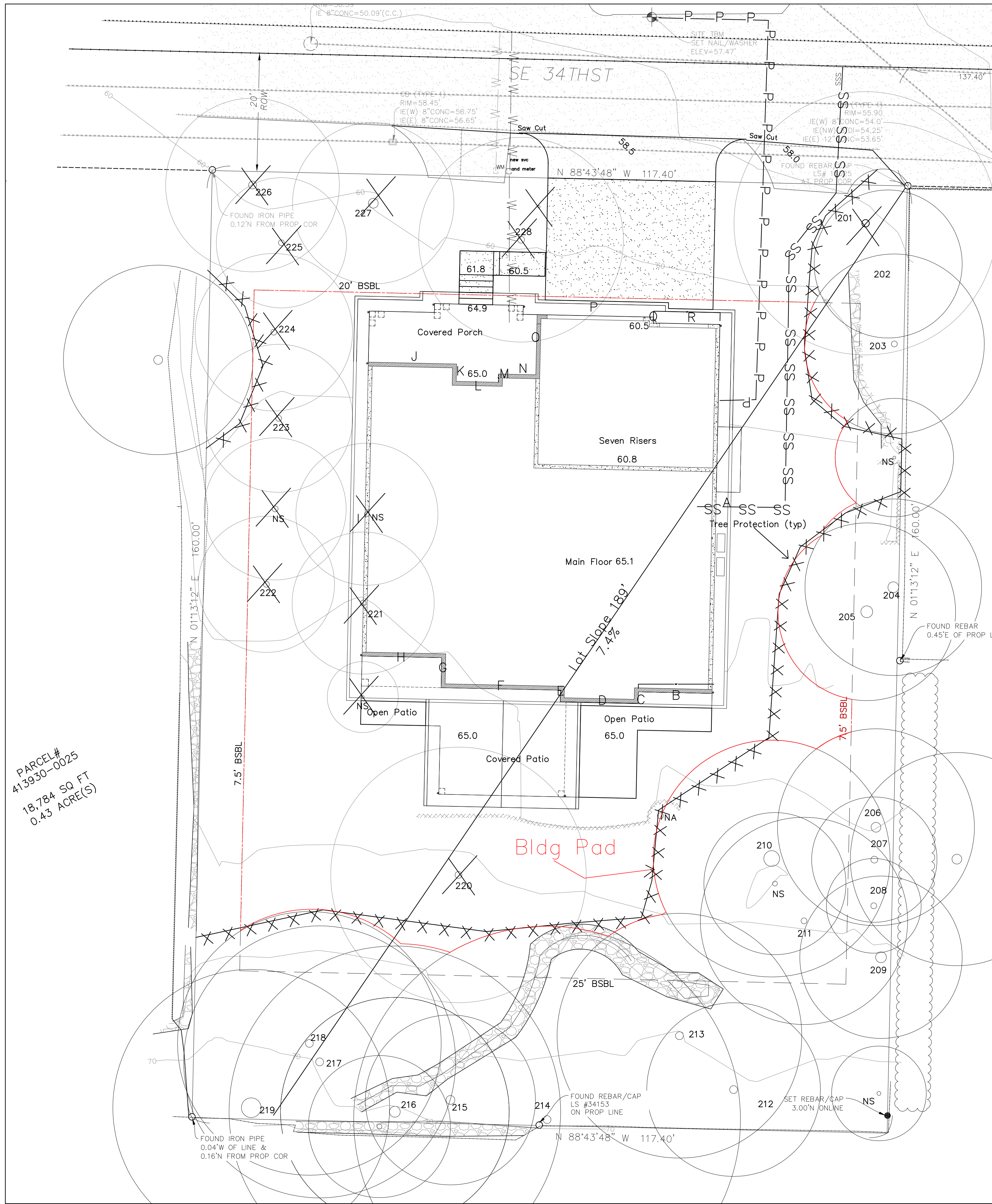

PARCEL #  
 413930-0025  
 18,784 SQ FT  
 0.43 ACRE(S)

**PROPERTY OWNER:**  
 Yen Fang Su  
**STREET ADDRESS:**  
 9619 SE 34th St  
**PARCEL #**  
 4139300025  
**ZONING R-9.6**  
**SINGLE FAMILY RES. SETBACKS**  
**FRONT YARD - 20'**  
**REAR YARD 25'**  
**SIDE YARD - 5'/15'**  
**HEIGHT LIMIT**  
 30' above average existing ground  
 elevation to peak of roof  
**Lot Coverage**  
 Maximum 40% of net lot area  
**Gross Floor Area**  
 Maximum 40% of net lot area

**PARKING**

Covered	3 ea.
Driveway	3 ea.

**LOT SLOPE CALCULATION**

High Point El:	71.2 ft
Low Point El:	57.2 ft
Elevation Difference	14 ft
Distance	189 ft
% Slope	7.4%

**HEIGHT TABLE**

Loc.	El:	Length	Product	Loc.	El:	Length	Product
A	61.8	62	3,832	M	61	1.5	92
B	63.5	12.7	806	N	61	6	366
C	63.3	2	127	O	61	10	610
D	63.4	13	824	P	61.5	20	1,230
E	63.4	2	127	Q	61.5	1	62
F	63.7	20	1,274	R	61.5	11	677
G	64.3	5	322				
H	64.5	13.5	871				
I	63	49.5	3,119				
J	60.9	15	914				
K	60.9	3	183				
L	60.9	7	426				
Sub Totals		204.7	12,823			49.5	3,036
Total						Length	254
AEG = Product/Length						Products	15,858
Maximum Height			30			ABE	62.4
Maximum Elevation			92.4				
Proposed Ridge Height			92.2				

**GROSS FLOOR AREA**

Main Floor/Main Living	2,659 sf
Main Floor Garage	762 sf
<b>Total Main Floor</b>	<b>3,421 sf</b>
Second Floor	3,097 sf
Second Floor Stair Deduction	(94) sf
<b>Total Second Floor</b>	<b>3,003 sf</b>
<b>Total GFA</b>	<b>6,424 sf</b>
Allowable GFA 40%	7,514 sf
Proposed %	34%

**TREE TABLE**

ID	Species	DBH				MLOD	RLOD	RETAIN	REMOVE
		DHS	Multistem	Dripline	Exceptional				
201	European White Birch	21		21.4		9	14		x
202	Hawthorn	11.5		12		6	8	x	
203	Hawthorn	17.1	7,11,11	14.7		7	11	x	
204	Western Red Cedar	23		14		10	15	x	
205	Western Red Cedar	25.4		14	Yes	11	21	x	
206	Western Red Cedar	19.9		15.8	Grove	8	17	x	
207	Western Red Cedar	11.8		10	Grove	6	10	x	
208	Lawson Cypress	11		7.5	Grove	6	9	x	
209	Grand Fir	19.6		12.8	Grove	8	16	x	
210	Doug-Fir	29		19	Grove	12	19	x	
211	Cherry Laurel	10.3		17	Grove	6	7	x	
212	Chinese photinia	12.8	11.6,5.4	14	Grove	6	9	x	
213	Horsechestnut	16.5		20	Grove	7	11	x	
214	Flowering Plum	17	12.1,12	32	Grove	7	11	x	
215	Horsechestnut	14.7		13.6	Grove	6	10	x	
216	Black Locust	20.7		18.4	Grove	9	14	x	
217	European White Birch	18.8	11,15.2	22.3	Grove	8	13	x	
218	European White Birch	15.3		21.6	Grove	6	10	x	
219	Western Red Cedar	40.1		21.7	Size and Grove	17	27	x	
220	Black Locust	15.0		21	Grove	6	10	x	
221	Apple	12		12		6	8	x	
222	Apple	13		11		6	9	x	
223	Apple	11.3		12		6	8	x	
224	Apple	12.8		10.5		6	9	x	
225	Apple	10.5		14.9		6	7	x	
226	Lawson Cypress	14		12.6		6	12	x	
227	Lawson Cypress	12.8		11.8		8	16	x	
228	Hawthorn	16.6		16.7		7	11	x	
Percentage Saved								64.0%	

**LOT COVERAGE**

Lot Area	18,784
Allowed	40%
Allowed sf	7,514
<b>New</b>	
Eave Area	4,855
Driveway	591
Cov'd Patio	incl above
<b>New sf</b>	<b>5,446</b>
<b>Existing</b>	
Eaves	3,178
Driveway	613
<b>Total Existing</b>	<b>3,791</b>
Existing Removed	(3,791)
<b>Net Existing</b>	<b>-</b>
<b>Total</b>	
<b>Total New and Exist</b>	<b>5,446</b>
<b>%</b>	<b>29.0%</b>

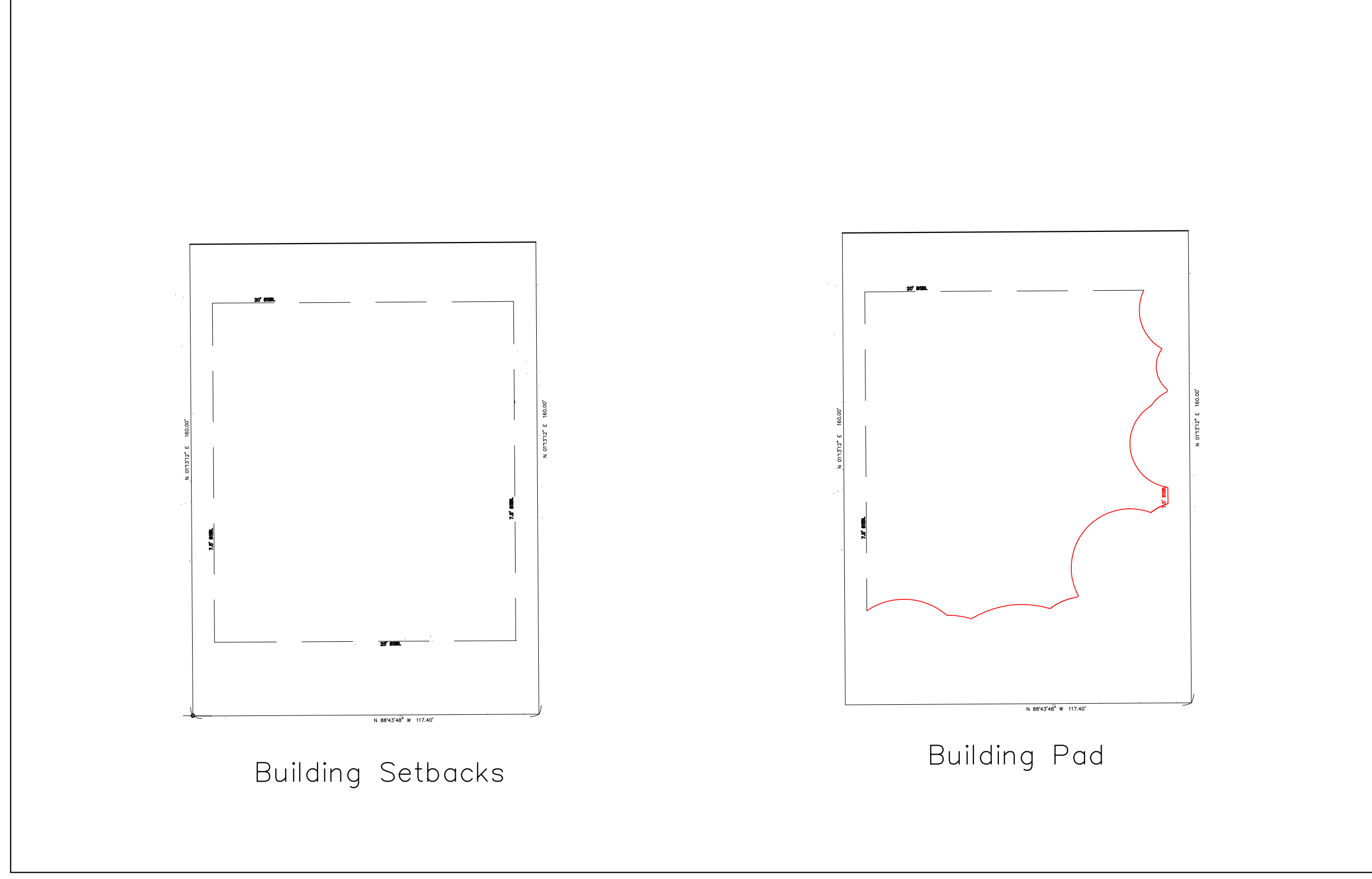
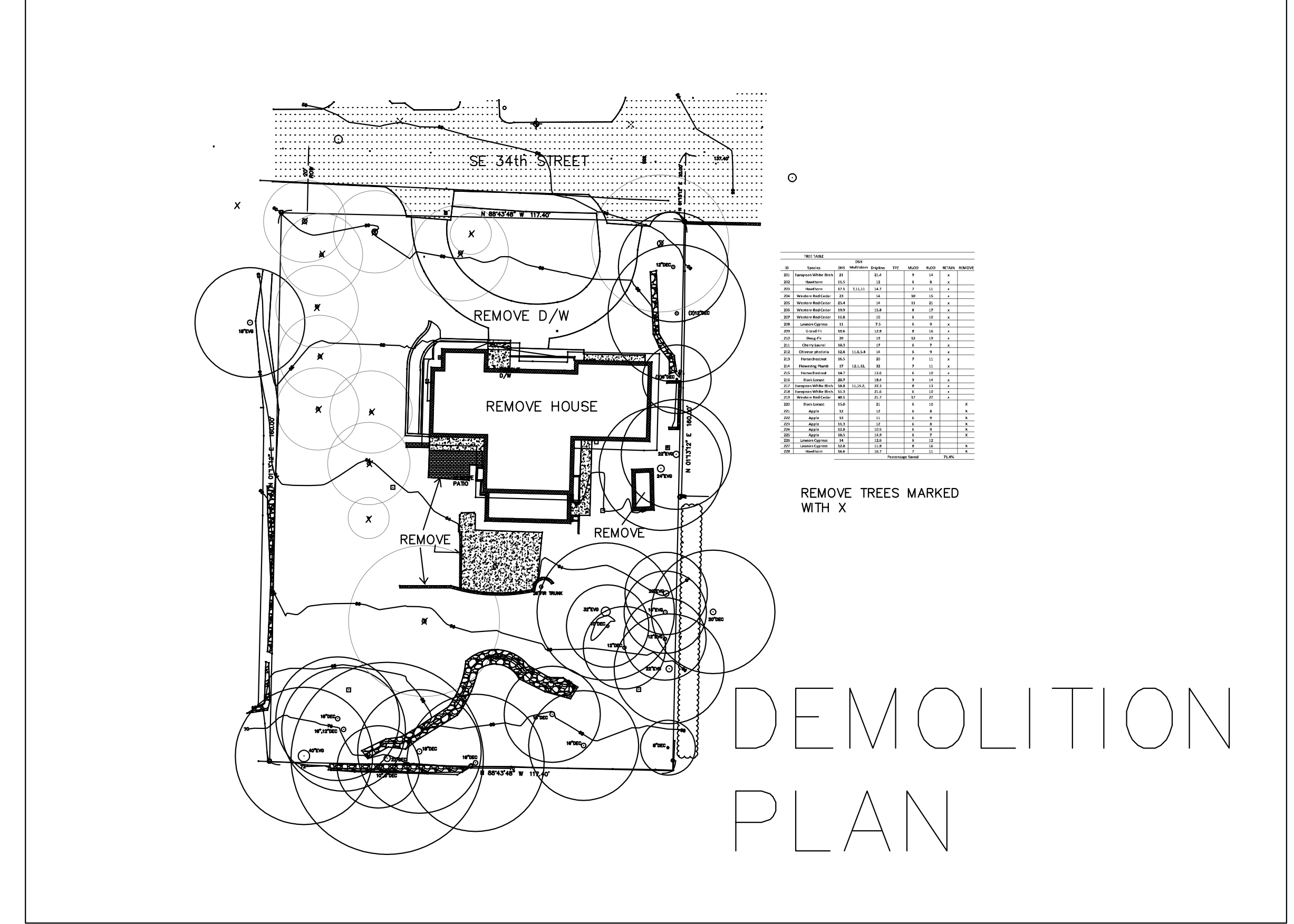

JayMarc Homes, LLC  
 7525 SE 24th St, #487  
 Mercer Island, WA 98040  
 425 281 2706

Site Plan  
 9619 SE 34th St.  
 Mercer Island, WA 98040

Drawn by  
 Gary Upper

1/31/24

A2.1

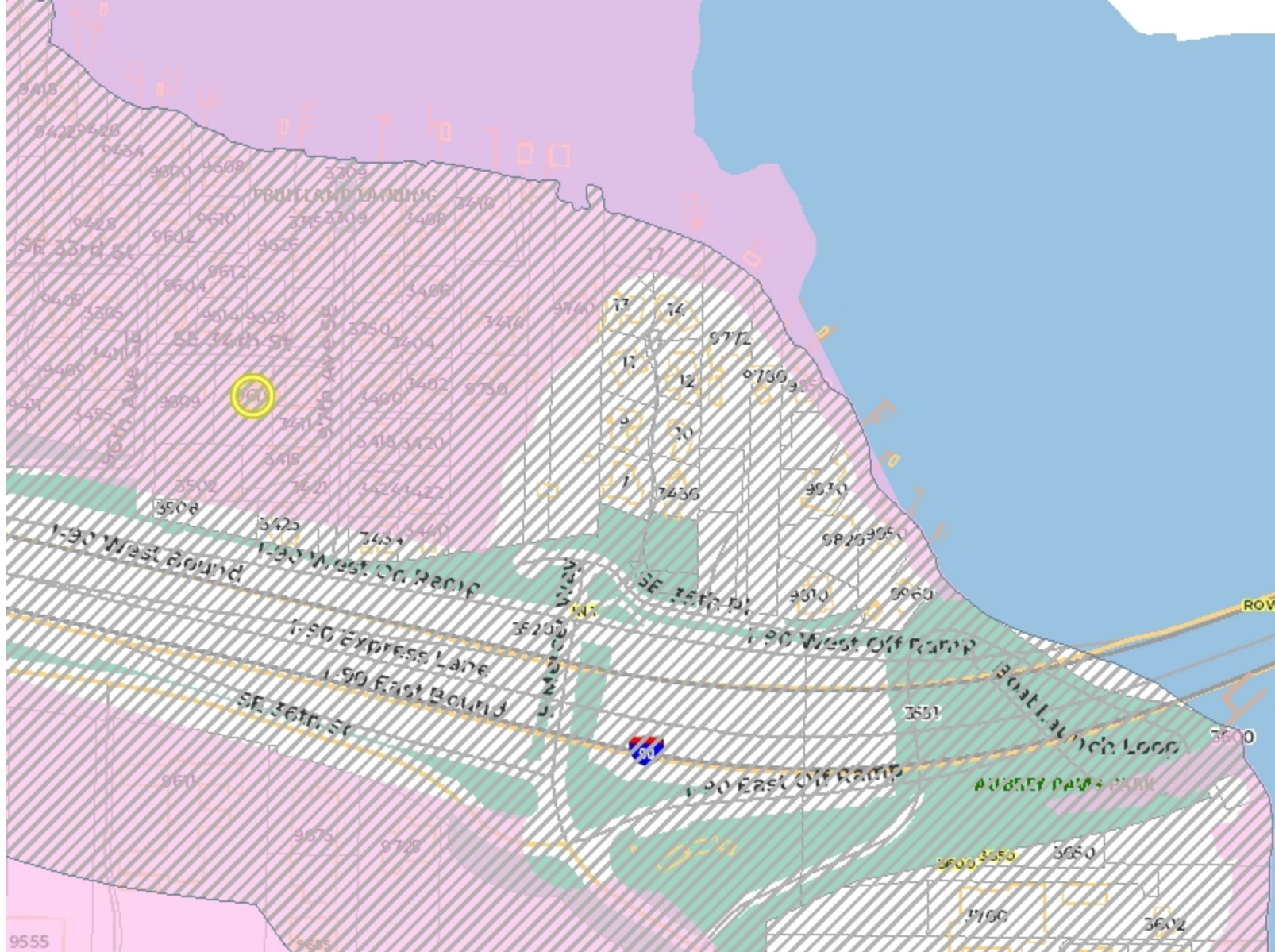

### Legend

- Wind Exposure
- Seismic
- Address
- Building
- Property Line
- Docks
- Freeway
- Major Street
- Street
- Parks
- Lake Washington

### Notes

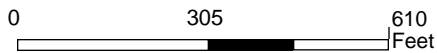





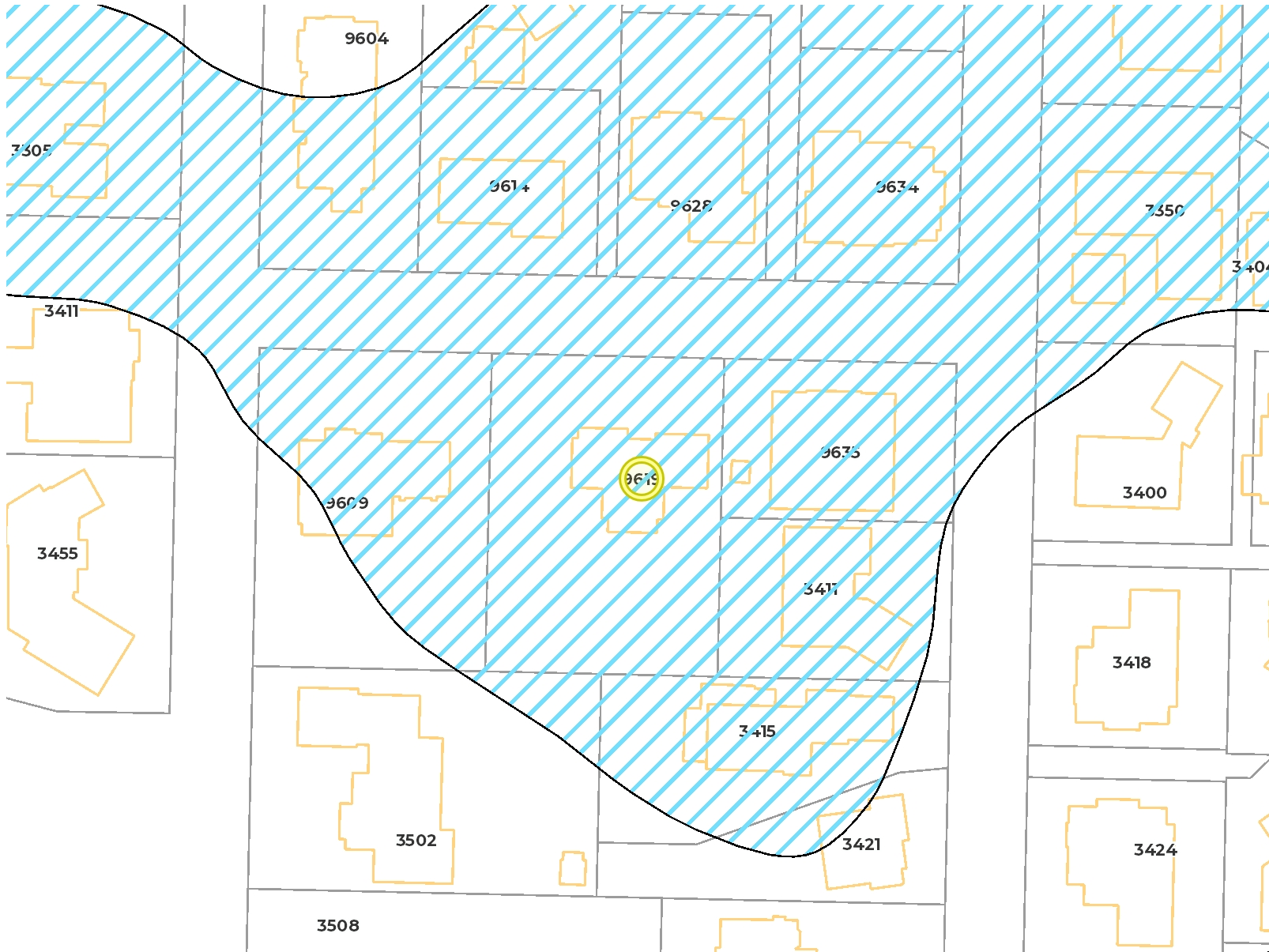

1 inch =  
610.331125833333  
feet



Disclaimer: These maps were developed by the City of Mercer Island and are intended to be a general purpose digital reference tool. These maps are not an accepted legal instrument for describing, establishing, recording or maintaining descriptions for property concerns or boundaries. The City makes no representation or warranty with respect to the accuracy or currency of these data sets, especially in regard to labeling of surveyed dimensions, or agreement with official sources such as records of survey, or mapped locations of features.



### Legend

-  Potential Slide
-  Steep Slope
-  Address
-  Building
-  Property Line
-  Docks

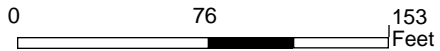

1 inch =  
152.5827815 feet



Disclaimer: These maps were developed by the City of Mercer Island and are intended to be a general purpose digital reference tool. These maps are not an accepted legal instrument for describing, establishing, recording or maintaining descriptions for property concerns or boundaries. The City makes no representation or warranty with respect to the accuracy or currency of these data sets, especially in regard to labeling of surveyed dimensions, or agreement with official sources such as records of survey, or mapped locations of features.

### Notes